



Origo™ Mag C172 / C202

Powerful and Compact

The Origo™ Mag C172 and C202 single phase MIG Welding machines are the ideal light industrial solution for welding applications in repair shops, automotive repairs, rural applications and maintenance work. These compact fully integrated welding power sources offer outstanding performance over a range of applications and materials.

MIG/MAG welding

The Origo Mag C172 and C202 machines can be used with both conventional solid wires and self-shielding cored wires. They are designed to provide exceptional welding quality and performance for :

- Mild steel
- Stainless steel
- Aluminium

Wire diameters from 0.6 mm up to 1.2 mm can be used depending on the choice of machine, materials and applications.

Easy to use

These units are equipped with a multi-step voltage switch and potentiometers for wire speed adjustment to enable easy setting of welding parameters.

It is possible to adjust burnback time and to set spot welding time in Origo™ Mig machines.

The units are fan-cooled and equipped with thermal overload protection.

As an option the Origo™ Mag C172/C202 can be equipped with V/A digital meter and transformer for CO₂ heater.



The Power Smoothing Device™

Although Origo™ Mag C172/C202 are 1-ph units, they utilize our Power Smoothing Device™ gives them excellent welding performance using both CO₂ and argon based gas mixture.

Torch included

Each machine is equipped with a gas cooled MXC 250 3M MIG torch. The MXC series of professional MIG torches have been designed to provide both operator comfort and reliable welding performance. ESAB's long life MIG torch consumables improve feedability, minimise downtime and improve your overall welding economics.

Applications

- Auto-repair
- Light metal fabrication
- Transport
- Education
- Household and furniture
- Tack welding

- **Power Smoothing Device™** - exceptional welding performance for single phase machines.
- **Easy change of polarity** – suitable for use with both conventional solid wire and self-shielding cored wire.
- **Easy setting of welding parameters** - welding machines for everyone
- **MXC Torches** - designed to provide the utmost in comfort and reliability

Technical data

	Origo™ Mag C172	Origo™ Mag C202
Mains voltage , V, Hz	230 (220-240), 1ph 50/60	230 (220-240), 1ph 50/60
Fuse, A-slow	16	16*
Auto fuse (MCB) EN 60898 typ D, A	16*	16*
Permitted load at 20% duty cycle, A	170	200
30% duty cycle, A	139	163
60% duty cycle, A	98	115
100% duty cycle, A	76	90
Setting range (DC) , A	30 - 170	30 - 200
Open circuit voltage , V	15.5 - 35.5	17.5 - 33
Open circuit power , W	145	240
Power factor at maximum current	0.90	0.83
Wire feed speed, m/min	1.0 - 17	1.0 - 17
Wire diameter, mm		
Fe, Ss	0.6 – 0.8	0.6 – 1.0
C	0.8	0.8 – 1.0
Al	1.0	1.0
CuSi	0.8 – 1.0	0.8 – 1.0
Burnback time, s	0.02 – 0.25 (adj.on the PCB)	0.02 – 0.25 (adj.on the PCB)
Spot welding, s	0.2 – 2.5	0.2 – 2.5
Voltage steps	8	12
Inductance outlets	1	1
Polarity change	YES	YES
Dimensions l x w x h, mm	860 x 425 x 830	840 x 425 x 830
Weight, kg	78	83
Operating temperature, °C	-10 to +40	-10 to +40
Enclosure class	IP 23	IP 23
Application classification	S	S



Origo™ Mag C172 / C202

* Mains voltage variations may effect duty cycle.

Wear parts Origo™ Mag C172/C202

Wire Ø mm	Wire type	1 Feed roller	2 Pressure roller	3 Inlet nozzle	4 Insert tube	5 Outlet nozzle	Groove type
0.6 / 0.8	Fe, Ss, C	367556-001	455907-001	466074-001	455889-001	455886-001	V
0.8 / 1.0	Fe, Ss, C	367556-002*	455907-001	466074-001	455889-001	455886-001	V
1.0 / 1.2	Fe, Ss, C	367556-003	455907-001	466074-001	455889-001	455886-001	V
1.0 / 1.2	Al	367556-004	455907-001	466074-001	455894-001	455885-001	U
	C=cored wire						

* Standard deliveries

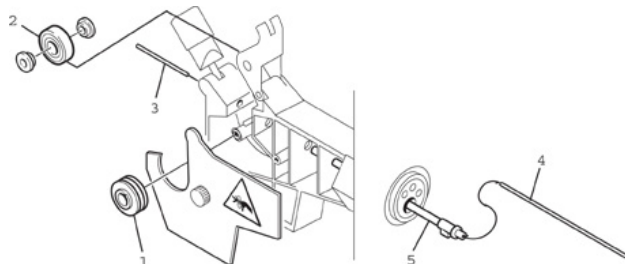

Ordering information

Origo™ Mag C172, 1 ph	0470 000 015
Origo™ Mag C172, 1 ph, Aust. version	0470 000 016
Origo™ Mag C202, 1 ph	0470 000 017
Origo™ Mag C202, 1 ph, Aust. version	0470 000 017

Digital instrument	0349 302 598
Transformer for CO ₂ heater (42V 50/60 Hz)	0349 302 250

Optional Accessories

WeldEasy 9-13 automatic helmet	0701 502 425
Three-row mild steel brush	0760 024 200
Chipping hammer SH2	0000 663 000
Nozzel Dip Gel, 400g	0069 300 601
Heavy Duty Basic Gloves	0700 005 007

Delivery content:

Delivered with 3 m mains cable with plug, 3 m return cable with clamp, MXC 250 3 m gas hose 1.5m, shelf for gas cylinder, attachment chain for gas cylinder, instruction manual.

Quality accessories for the quality welder
ESAB offers a wide range of accessories. The complete range, along with product information, is available at our local web-sites, www.esabasia.com or contact your local ESAB dealer.



ESAB Asia/Pacific Pte Ltd
38 Joo Koon Circle, Jurong
Singapore 620063
Phone: +65 6861 4322 Fax +65 6 861 3195
E-mail: machines@esabasia.com
www.esabasia.com

